

### 3. 35 GA CONCENTRIC RING VALVE ASSEMBLY - MODEL 71T2

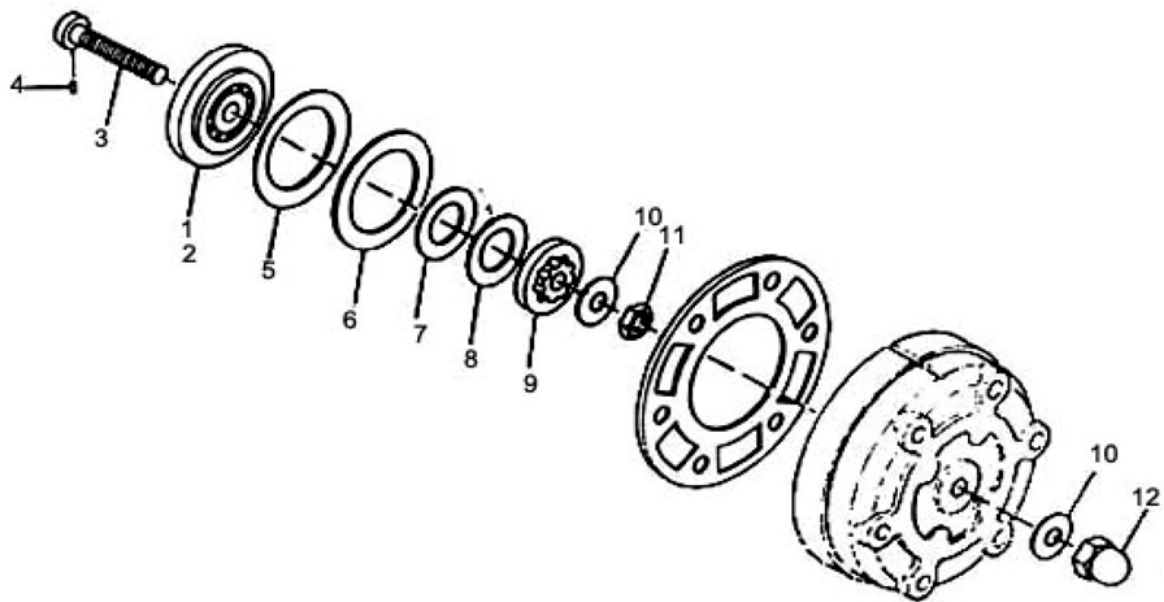

### 3. 35 GA CONCENTRIC RING VALVE ASSEMBLY - MODEL 71T2

No.	Description	Ref Part No.	QTY
3-1	Valve complete	37004827	1
3-2	– Seat discharge valve	30217608	1
3-3	– Bolt valve	30220925	1
3-4	– – Pin bolt	37002656	1
3-5	– Spring inlet valve	30221501	1
3-6	– Plate inlet valve	30181499	1
3-7	– Plate discharge valve	30215941	1
3-8	– spring discharge valve	30221576	1
3-9	– Plate discharge valve stop	30218994	1
3-10	– Washer spring belleville	37092913	2
3-11	– Nut hex	95076808	1
3-12	– Nut acorn	30287643	1